

Lay out

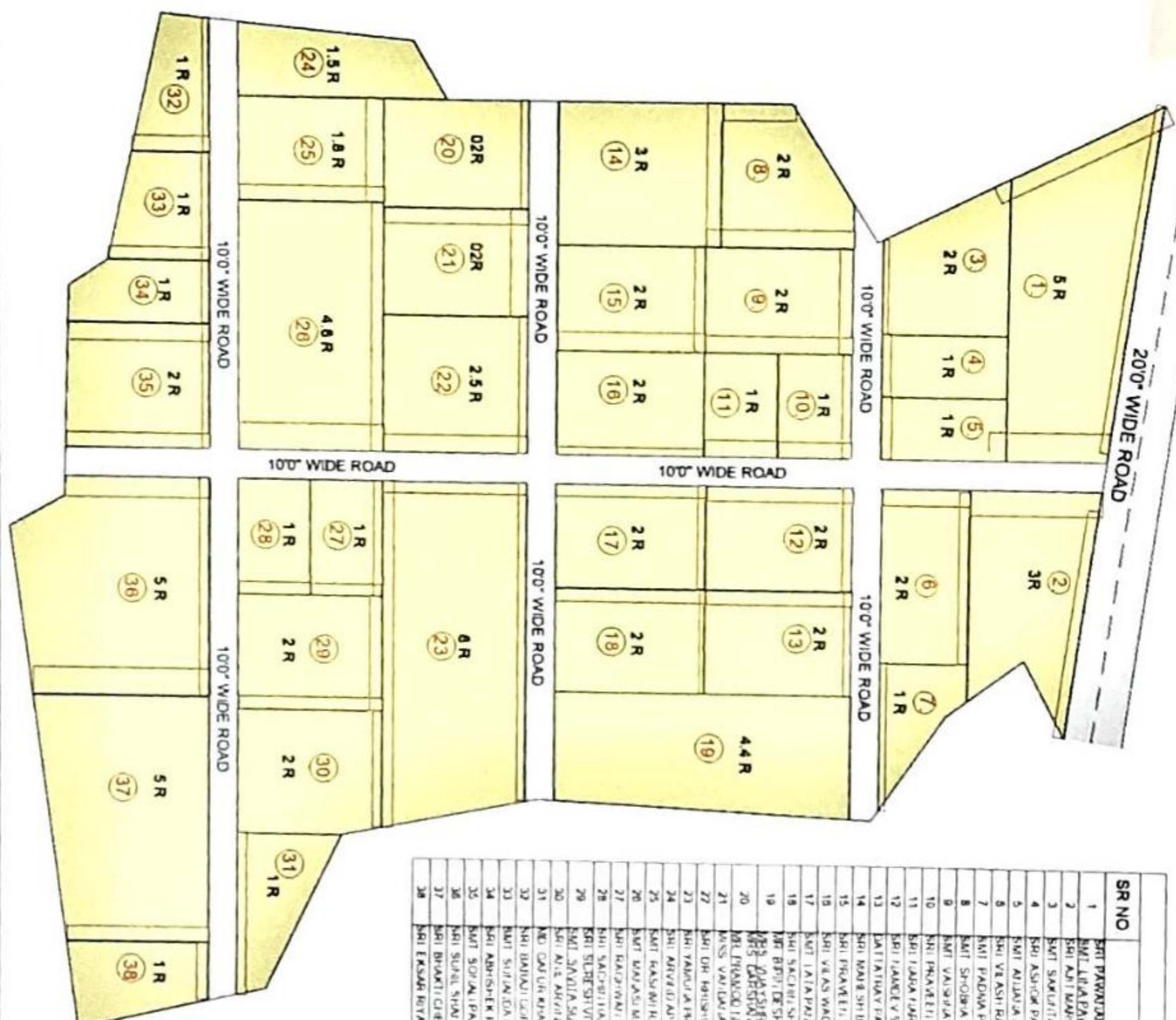

GUT NO - 171 / 1

| SR NO | CUSTOMER NAME | PUR. AREA | PLOT NO |
|-------|--------------------------------------|-----------|---------|
| 1 | SRI PRAKASH VASDEV VANTERGI | 3.8 | 2 |
| 2 | SRI LALADWARJI VADLERI | 5.8 | 1 |
| 3 | SRI KANT RAMJI BHOIRATE | 2.8 | 3 |
| 4 | SRI SANKUTIKA DEVI SINGHSHI GUPTA | 2.8 | 4 |
| 5 | SRI ASHOK PANDURANG JADAV | 1.8 | 5 |
| 6 | SRI AJAYJI KANTJI GAKHAD | 2.8 | 6 |
| 7 | SRI VIKASH RAJCHANDRAN KADAM | 1.8 | 7 |
| 8 | SRI PADMINI DUTI DAVE | 1.8 | 8 |
| 9 | SRI SHOBHA RAJARAM SHIRALKAR | 2.8 | 9 |
| 10 | SRI VAISNAVJI VANT JAVDE | 1.8 | 10 |
| 11 | SRI PHARTEJI RAMDEV GURAV | 1.8 | 11 |
| 12 | SRI JIJAN JIJANVAJI PANGIA | 4.8 | 12 |
| 13 | SRI JALDEVY SOMWANDE | 3.8 | 13 |
| 14 | SRI ATILAVJI PAVANI | 2.8 | 14 |
| 15 | SRI MANI SHIBUSHE | 2.8 | 15 |
| 16 | SRI PHARTEJI SHIRDE | 2.8 | 16 |
| 17 | SRI VIKAS WACH | 2.8 | 17 |
| 18 | SRI JATAJI PANDURANG | 1.5 | 18 |
| 19 | SRI SACHIN SHIBUDE | 1.8 | 19 |
| 20 | SRI BHUPENDRAJI SHIRDE | 6.8 | 20 |
| 21 | SRI CHANDRANATHJI SHIRDE | 2.8 | 21 |
| 22 | SRI PRAMODJI KUMARJI | 2.8 | 22 |
| 23 | SRI VANDANA PANDURANG SARWARKAR | 5.8 | 23 |
| 24 | SRI DR. HANSHING SH. SAKURBARI PATIL | 5.8 | 24 |
| 25 | SRI YANAJA PANDURANG SOMWANDE | 5.8 | 25 |
| 26 | SRI ANANDJI ANANDJI CHAVR 018 | 1.8 | 26 |
| 27 | SRI KASHIJI HANUJIJI MOHAPATRA | 1.8 | 27 |
| 28 | SRI KUNJASINI SHILKATE | 2.8 | 28 |
| 29 | SRI RAJENDRAJI SHILKATE | 2.8 | 29 |
| 30 | SRI SACHINJI RAJENDRAJI SHILKATE | 2.8 | 30 |
| 31 | SRI SURESHJI VITTHALJI YEDAV | 4.8 | 31 |
| 32 | SRI JAYATIJI SHILSHI THERGI | 1.8 | 32 |
| 33 | SRI ANIL ANANDJI KADAM | 1.8 | 33 |
| 34 | SRI CHITURJI KANTJI PATIL | 2.8 | 34 |
| 35 | SRI BHADRIJI CHITURJI PATIL | 2.8 | 35 |
| 36 | SRI SHYAMJI DASHIRAJI SHIRDE | 1.8 | 36 |
| 37 | SRI ABHISHEKJI PHADURANG PANGAD | 1.8 | 37 |
| 38 | SRI SODALJI PHADURANG GORE | 1.8 | 38 |
| 39 | SRI SURESHJI SOMNATHJI KARDALE | 1.8 | 39 |
| 40 | SRI BHAKTIJI CHITURJI THAPRIYANJI | 1.8 | 40 |
| 41 | SRI ESHANJI RAVAJI GADKARI | 1.8 | 41 |

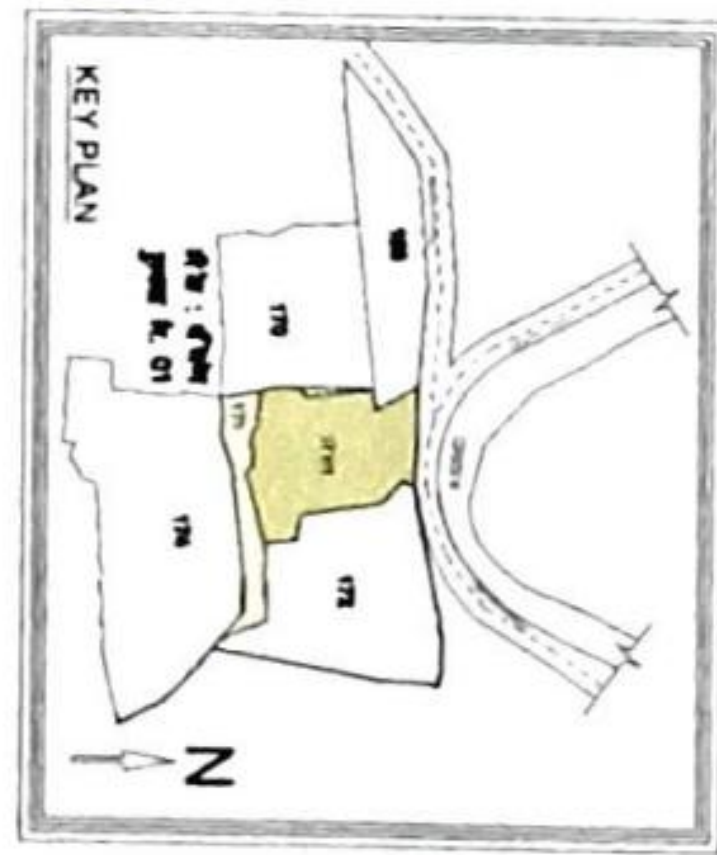

JOB TITLE:-
TENTATIVE
LAY OUT PLAN

TOTAL AREA :- 83.80 R
(91258 SQ.FT.)
Average loading - 5-8%

GAON :- VINDHANE
G.NO. :- 171/1

OFFICE ADDRESS:-
INFRA TECH, 1507/ 15TH FLOOR
GREENSCAPE, CYBERONE TOWER,
SECTOR-30 OPP. CIDCO EXHIBITION CENTRE VASHI
MAHARASTRA- 400703